

Location of proposed disabled parking bays

Appendix C

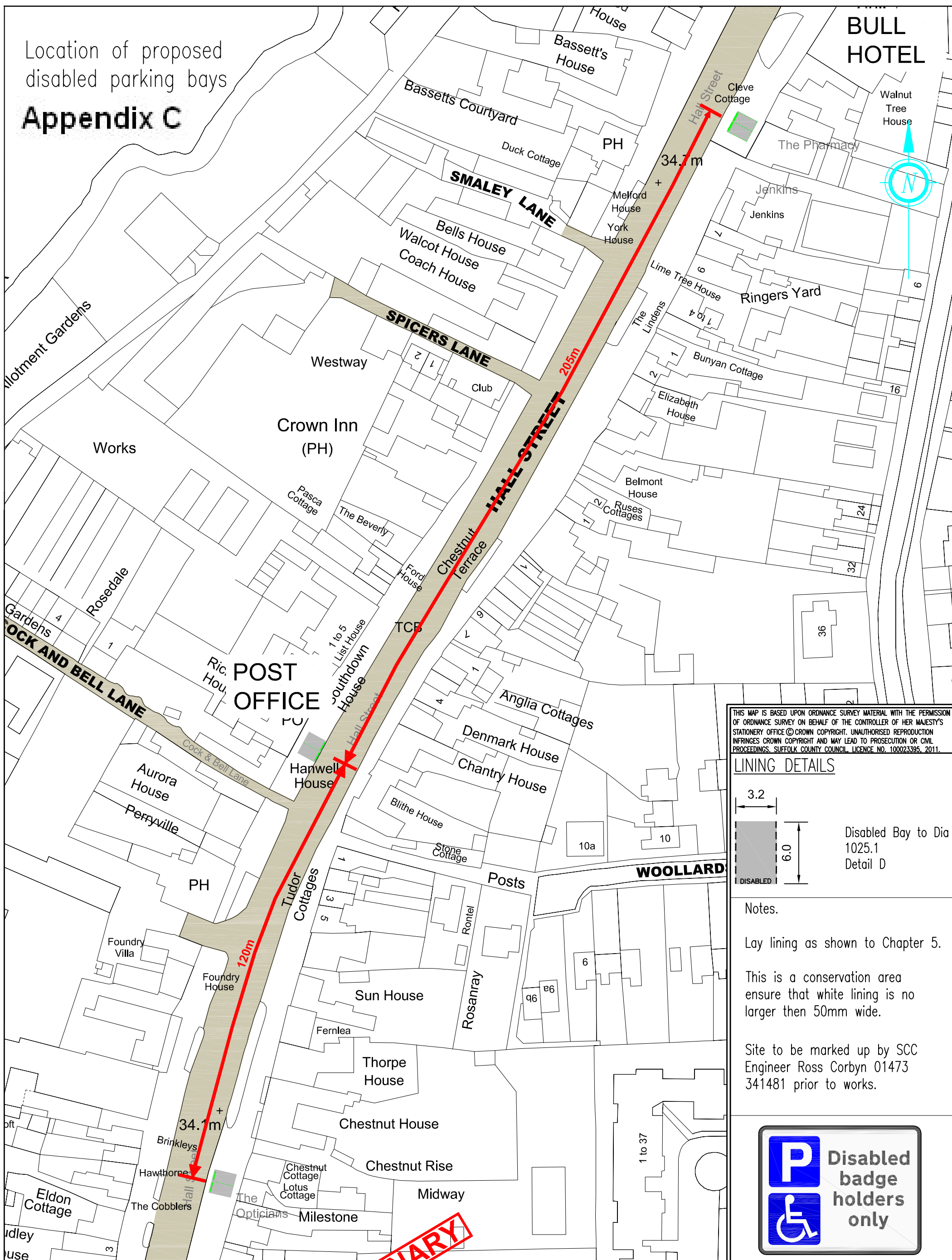

THIS MAP IS BASED UPON ORDNANCE SURVEY MATERIAL WITH THE PERMISSION OF ORDNANCE SURVEY ON BEHALF OF THE CONTROLLER OF HER MAJESTY'S STATIONERY OFFICE © CROWN COPYRIGHT. UNAUTHORISED REPRODUCTION INFRINGES CROWN COPYRIGHT AND MAY LEAD TO PROSECUTION OR CIVIL PROCEEDINGS. SUFFOLK COUNTY COUNCIL, LICENCE NO. 100023395, 2011.

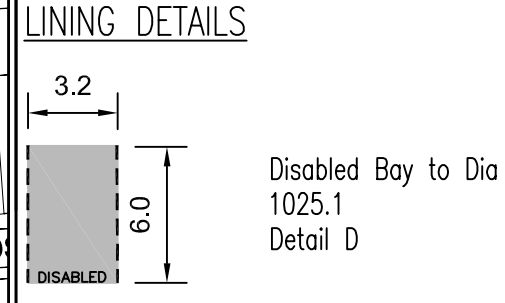

Notes.

Lay lining as shown to Chapter 5.

This is a conservation area ensure that white lining is no larger than 50mm wide.

Site to be marked up by SCC Engineer Ross Corbyn 01473 341481 prior to works.



PRELIMINARY



Lucy Robinson. Director of Economy, Skills & Environment
Endeavour House, 8 Russell Road, Ipswich, Suffolk. IP1 2BX.

REVISION(S)	PROJECT TITLE	ORIGINATOR	CHECKER	DESIGNER	REVIEWER
	Long Melford TRO Hall Street Disabled Bays	RJC		RJC	
	DRAWING TITLE Disbled Bay Locations Details	SCALE(S) ORIGINAL SIZE A3 N.T.S	DATE May 2012	DRAWING NUMBER ETC04670-02	REVISION
DESCRIPTION	REV.	DATE	INTL.		