

Proposed Single Yellow Lining

Proposed Double Yellow Lining

New Road Signs

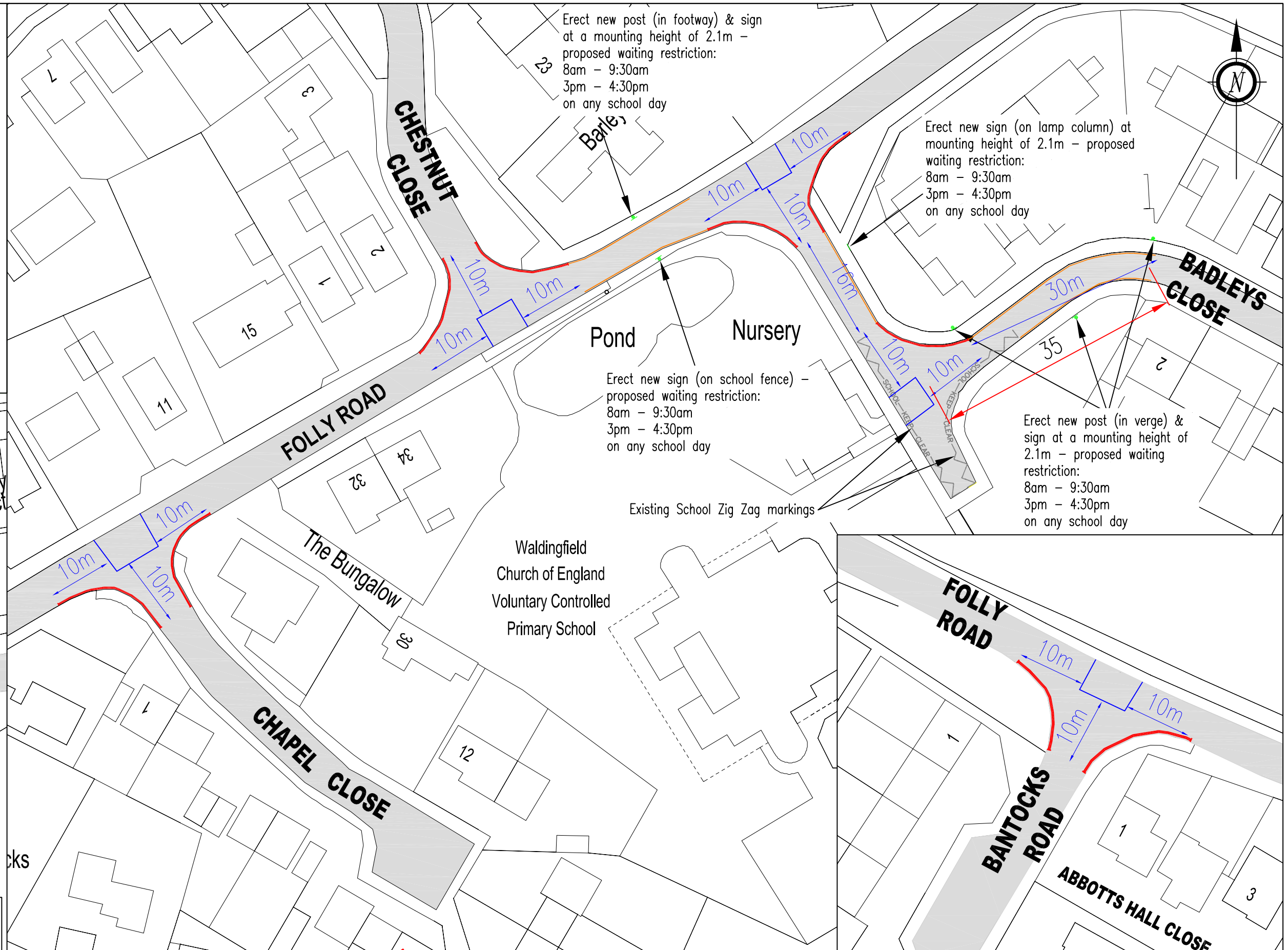

THIS MAP IS BASED UPON ORDNANCE SURVEY MATERIAL WITH THE PERMISSION OF ORDNANCE SURVEY ON BEHALF OF THE CONTROLLER OF HER MAJESTY'S STATIONERY OFFICE © CROWN COPYRIGHT. UNAUTHORISED REPRODUCTION INFRINGES CROWN COPYRIGHT AND MAY LEAD TO PROSECUTION OR CIVIL PROCEEDINGS. SUFFOLK COUNTY COUNCIL, LICENCE NO. 100023395, 2011.



Appendix B

PRELIMINARY

REVISION(S)	REV.	DATE	INTL.
A Additional Lines added in Badleys Close	A	01.04.12	RJC
B TRO proposals adjusted to support highway Code Rule 243 "DO NOT stop or park opposite or within 10m of a junction, except in an authorised parking space."	B	03.08.12	NMT
C remove double yellows opposite intersections	C		

PROJECT TITLE TRO WALDINGFIELD	ORIGINATOR RJC	CHECKER PRELIM	DESIGNER RJC	REVIEWER PRELIM
DRAWING TITLE CONSULTATION PLAN	SCALE(S) N.T.S.	ORIGINAL SIZE A1	DATE ---	REVISION C
	DRAWING NUMBER ETC04675-01			